

INLET GRILL

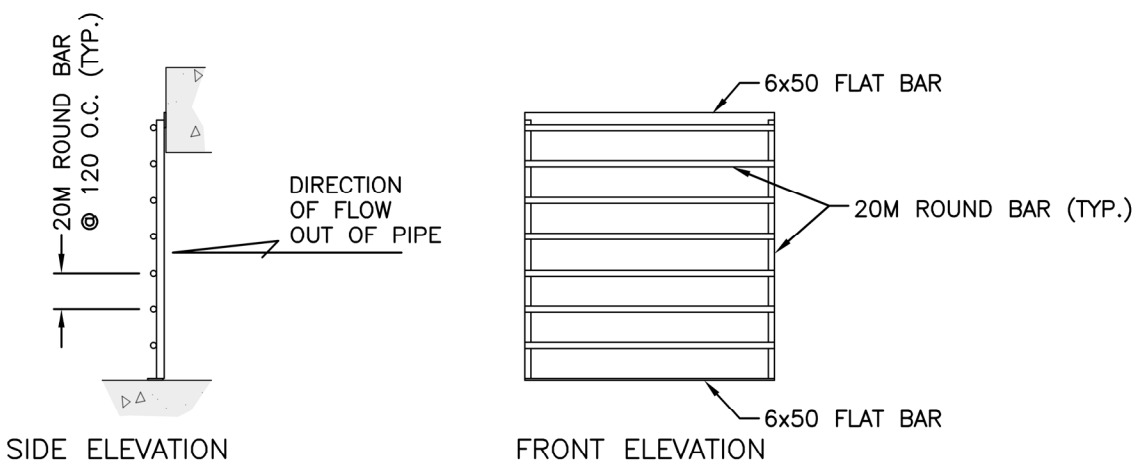

OUTLET GRILL

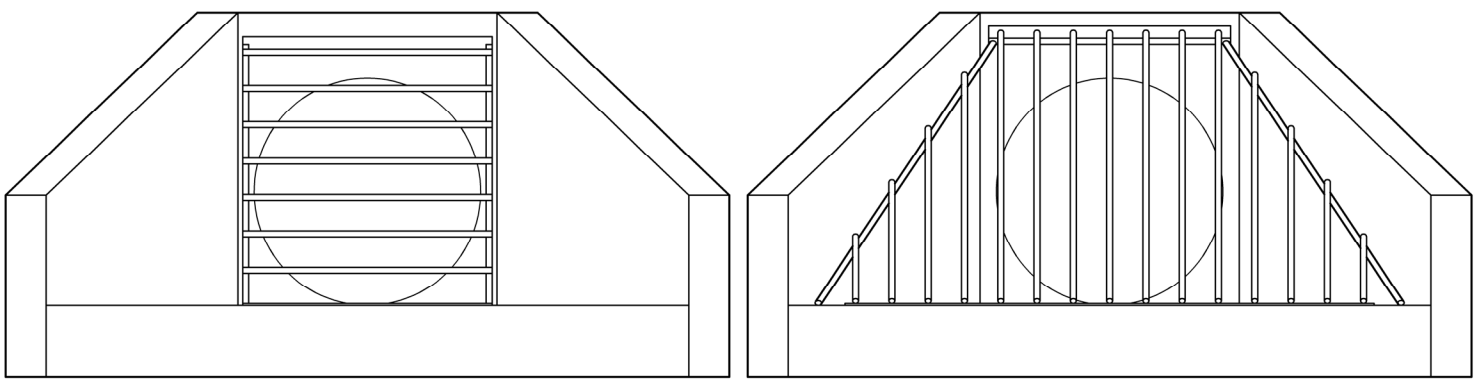

OUTLET

INLET

- NOTE:
1. INSTALL SAFETY HANDRAIL AS PER DRAWING SS13, AS REQUIRED.
 2. PRECAST UNIT MAY BE PROVIDED AS ALTERNATIVE WITH CONTRACT ADMINISTRATOR'S PRIOR APPROVAL.
 3. ALL STEEL COMPONENTS TO BE HOT DIPPED GALVANIZED AFTER FABRICATION.
 4. SAFETY GRILLAGE TO BE WELDED AT ALL JOINTS AND CONNECTIONS EXCEPT AT ANCHOR BOLTS. MINIMUM OF 4 ANCHOR BOLTS REQUIRED FOR EACH GRILLAGE.
 5. REFER TO CONTRACT DRAWINGS FOR LOCATIONS AND SITE SPECIFIC DIMENSIONS. REFER TO SECTIONS 03 20 01 AND 03 30 53 FOR DETAILED SPECIFICATIONS.
 6. GRILLAGE REQUIRED FOR 300mmØ PIPE AND LARGER.

NOT TO SCALE

No.	DATE	REVISION DESCRIPTION	BY	APP
4	MAR2023	DIRECTION OF FLOW	DAR	Jdh
3	FEB2019	REVIEWED AND UPDATED 2019	DAR	Jdh

HEADWALL
GRILLAGE



DWG. No. SS14
REV. 4